



Broadhurst Gardens NW6

Parkheath
Sold on Service





Broadhurst Gardens, NW6

£650,000

Leasehold

- 2 bedroom apartment in the heart of West Hampstead
- 2nd floor within period building
- Under floor heating (except in the bathroom)
- 2 double bedrooms with fitted carpet
- Luxury bathroom
- Reception room with wood flooring
- Open plan kitchen with integrated appliances
- Large communal storage room with a bike rack
- Secure private storage cupboard in the basement
- Situated within a couple of hundred yards of West Hampstead underground station

Belsize Park/Hampstead
208 Haverstock Hill
NW3 2AG
Sales 020 7431 1234
Lettings 020 7431 3104
nw3@parkheath.com

South/West Hampstead
192 West End Lane
NW6 1SG
Sales & Lettings
Tel 020 7794 7111
192@parkheath.com

Kensal Rise
54-56 Chamberlayne Rd
NW10 3JH
Tel 020 8960 4845
kensal@parkheath.com

Property Management
192 West End Lane
NW6 1SG
020 7433 6174
pm@parkheath.com

Parkheath
Sold on Service

Camden Tax band C

www.parkheath.com

Broadhurst Gardens

Approximate Gross Internal Area = 62.00 sq m / 669 sq ft

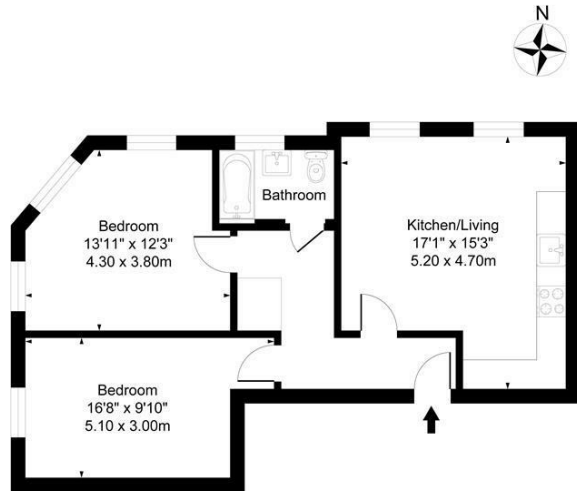

Second Floor

This plan is for layout guidance only. Drawn in accordance with RICS guidelines. Not drawn to scale unless stated. Windows & floor openings are approximate. Whilst every care is taken in the preparation of this plan, please check all dimensions, shapes & bearings before making any decisions reliant upon them.

ELLIE CLAIRE PHOTOGRAPHY LTD
www.ellieclairephotography.com

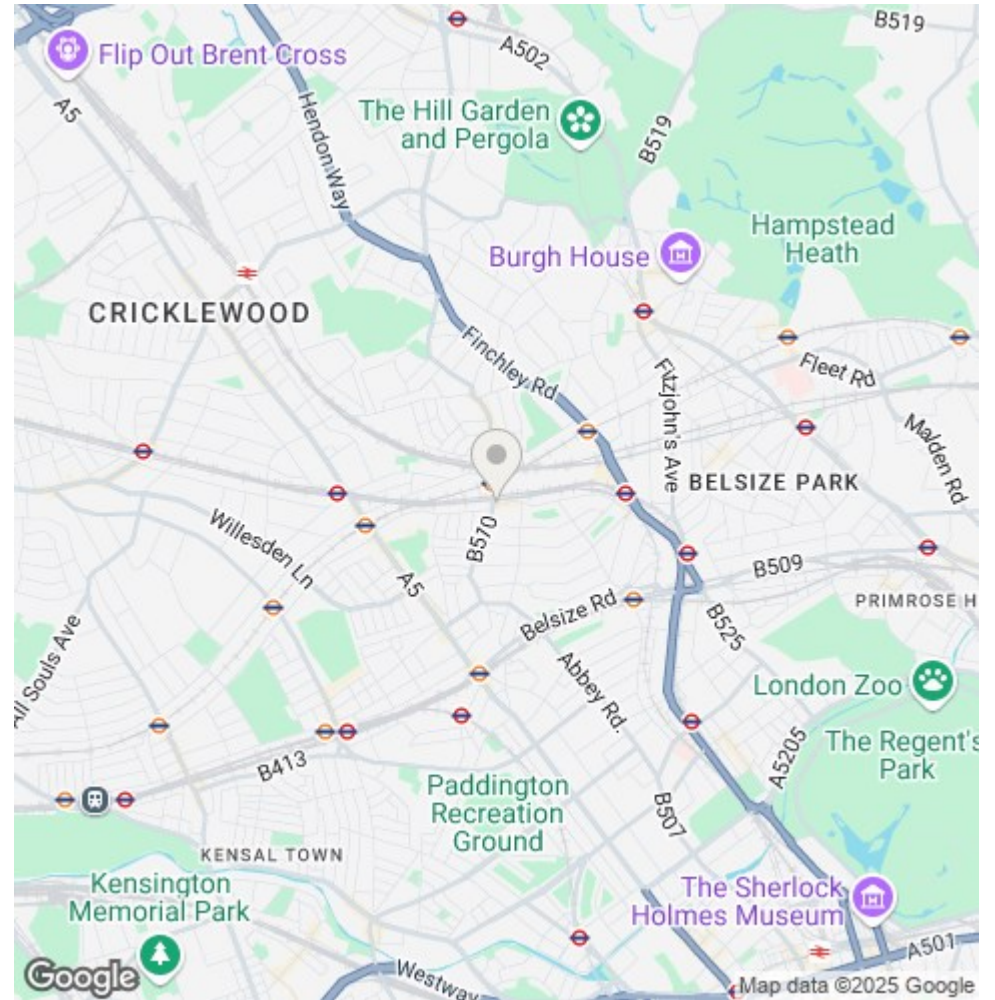

The particulars do not constitute part of an offer or contract. The particulars, including text, photographs and plans, are for the guidance only of prospective purchasers/tenants and must not be relied upon as statements of fact. The descriptions provided therein represent the opinion of the author and whilst given in good faith should not be construed as statements of fact. Nothing in these particulars shall be deemed a statement that the property is in good condition or otherwise or that any services or facilities are in good working order. All measurements are approximate